

上胴縁取付詳細 S=1/5

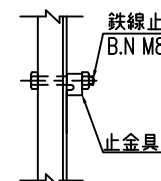

鉄線取付詳細 S=1/5

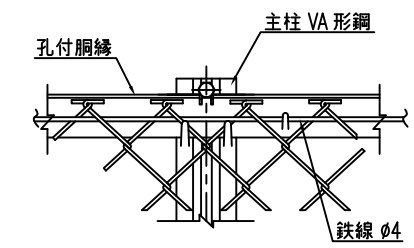
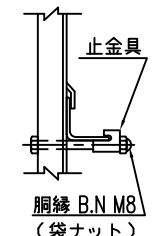
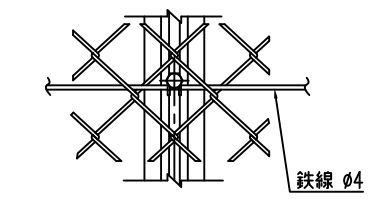

下胴縁取付詳細 S=1/5

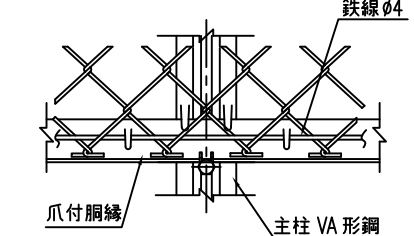

隅柱取付詳細 S=1/5

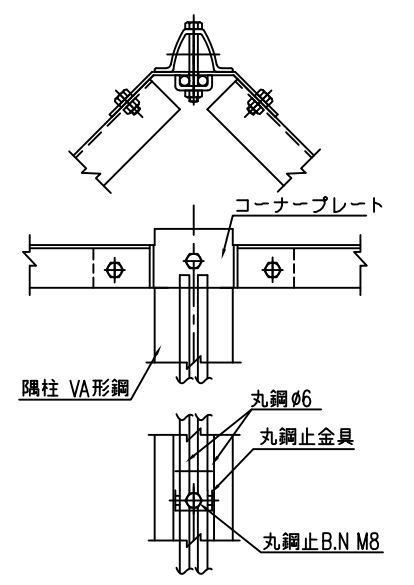

直角 隅柱取付詳細 S=1/5

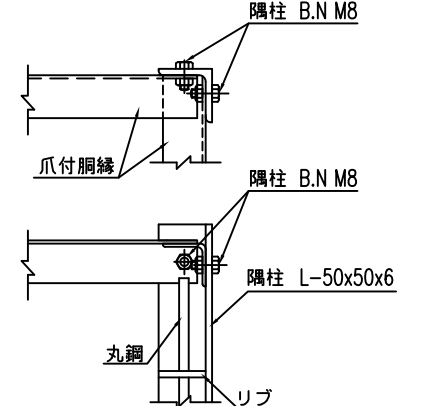

主柱断面図 (VA) S=1/1

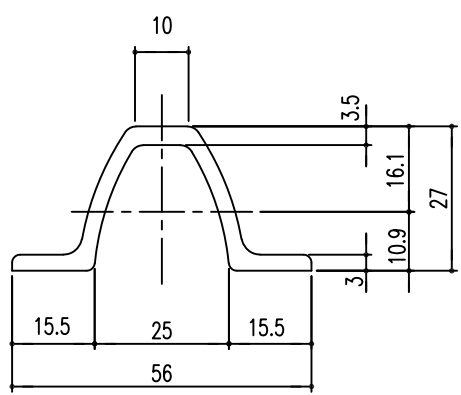

胴縁断面図 S=1/1  
(R付L40x40x3)

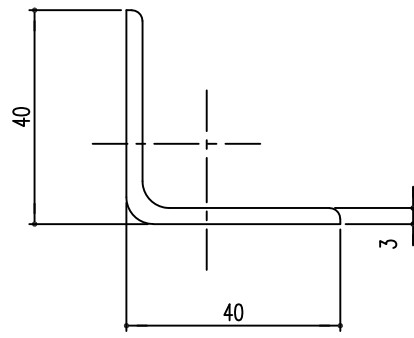

継手ピース取付詳細 S=1/5

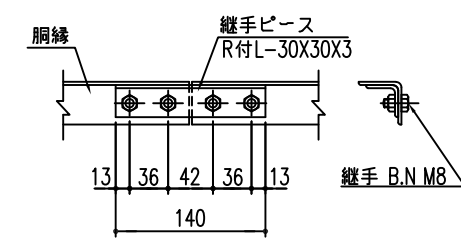

端柱取付詳細 S=1/5

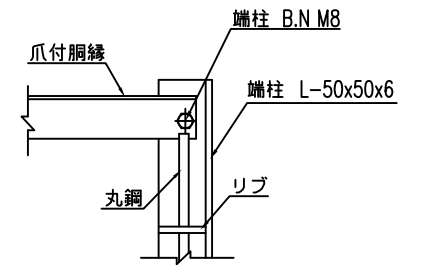

型式	VA5型H800	No.	Va5h08-h
JFE 建材株式会社			

(設計条件) 風荷重：昭和57年改正 建築基準法・同施行令に基づく風圧力に準拠。  
(基礎条件) 長期許容地耐力98kN/m<sup>2</sup>の場合。